

Date: 2/19/2023

Air handling unit model:

**DOMEKT-R-400-H-R1-F7/M5-C6M-L/A**

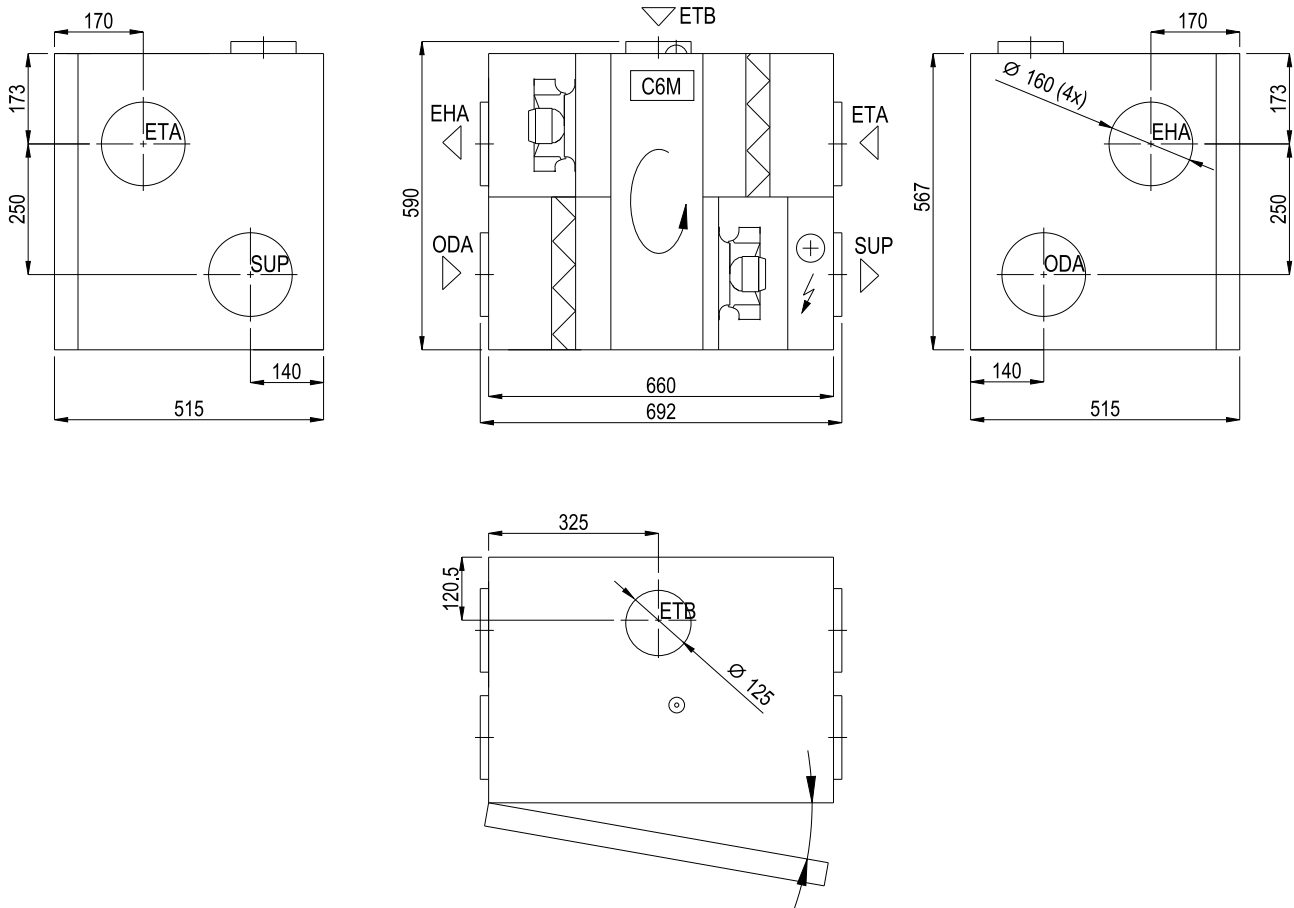

ODA - outdoor air  
 SUP - supply air  
 ETA - extract air  
 EHA - exhaust air

**TECHNICAL SPECIFICATION**

Unit category		RVU
Unit type		BVU
Type of HRS		Rotary Heat Exchanger
Panel thickness	[mm]	45
Dimensions bxhxl	[mm]	515×567×660
Duct connection	[mm]	4×160 1×125
Filter dimensions bxhxl	[mm]	417×210×46
Mass	[kg]	49
Max current	[A]	7.3
Supply voltage	[V]	1~ 230
Color		RAL 9003
Version		Horizontal

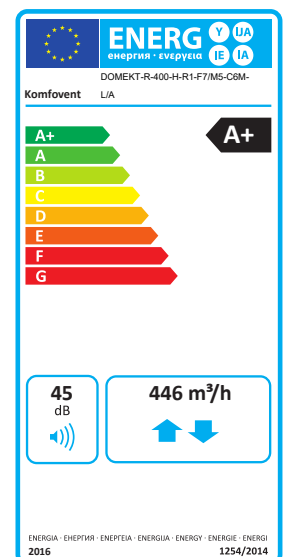

DOMEKT-R-400-H-R1-F7/M5-C6M-L/A

Inspection side		Right
Heater		Electric
Motor type		EC motor
Controller		C6M
SPI	[W/(m <sup>3</sup> /h)]	0.27

**INPUT DATA**

Supply		
Nominal flow rate	[m <sup>3</sup> /h]	342
Nominal external pressure ( $\Delta P_s$ , ext.)	[Pa]	130
Exhaust		
Nominal flow rate	[m <sup>3</sup> /h]	342
Nominal external pressure ( $\Delta P_s$ , ext.)	[Pa]	130
Climate parameters		
Winter		
Outdoor temperature	[°C]	-25.0
Outdoor relative humidity	[%]	90.0
Summer		
Outdoor temperature	[°C]	28.0
Outdoor relative humidity	[%]	50.0
Set point temperature		
Winter	[°C]	18.0

**CALCULATION DATA IN SPECIFIED WORKING POINT**

<b>AHU data</b>		
SFP	[kW/(m <sup>3</sup> /s)]	1.44

<b>Filter data</b>			
		Supply	Exhaust
Filter class(EN ISO 16890)		ePM1 55% (F7)	ePM10 50% (M5)
Pressure drop (clean filter)	[Pa]	44	26

<b>Heat exchanger data</b>					
		Winter		Summer	
		Supply	Exhaust	Supply	Exhaust
Actual temp. efficiency	[%]	83.0		83.0	
Humidity efficiency	[%]	10.2		0.0	
Face velocity	[m/s]	1.9	1.9	1.9	1.9
Pressure drop	[Pa]	106	106	106	106
Inlet temperature	[°C]	-25.0	18.0	28.0	24.0

**DOMEKT-R-400-H-R1-F7/M5-C6M-L/A**

Inlet rel. humidity	[%]	90	25	50	50
Outlet temperature	[°C]	10.7	-17.7	24.7	27.3
Outlet rel. humidity	[%]	8	95	61	41

Energy recovery					
Sensible heat	[kW]	4.1		-0.4	
Latent heat	[kW]	0.1		0.0	
Total heat	[kW]	4.2		-0.4	
OACF		1.15		1.15	

**Electric heater data**

			Winter		
Capacity	[kW]	0.84			
Outlet temperature	[°C]	18.0			
Outlet rel. humidity	[%]	5.0			
Max power	[kW]	1.0			

**Fans data**

Input power	[W]	170.0			
Max current	[A]	1.4			
Nominal voltage	[V]	230			
Overall efficiency	[%]	53			
			Supply	Exhaust	
Rotating speed	[RPM]	2,952	2,896		
Running current	[A]	0.60	0.58		
Static pressure	[Pa]	378	361		
Usable power	[W]	70	67		
Specific fan power	[kW/(m³/s)]	0.74	0.70		

**ACOUSTICS DATA**

Frequency	[Hz]	63	125	250	500	1000	2000	4000	8000	dB(A)
Outdoor Lw	[dB]	65	55	64	55	51	52	51	46	60
Supply Lw	[dB]	67	60	70	64	63	63	61	56	70
Extract Lw	[dB]	64	54	63	54	50	52	50	46	60
Exhaust Lw	[dB]	66	59	69	63	63	63	61	56	69
Casing Lw	[dB]	61	52	57	42	40	37	29	23	50
Casing Lp 1 m	[dB]	58	49	52	38	36	33	25	19	46
Casing Lp 3 m	[dB]	53	44	44	30	30	25	19	13	38

DOMEKT-R-400-H-R1-F7/M5-C6M-L/A

**PLOT**

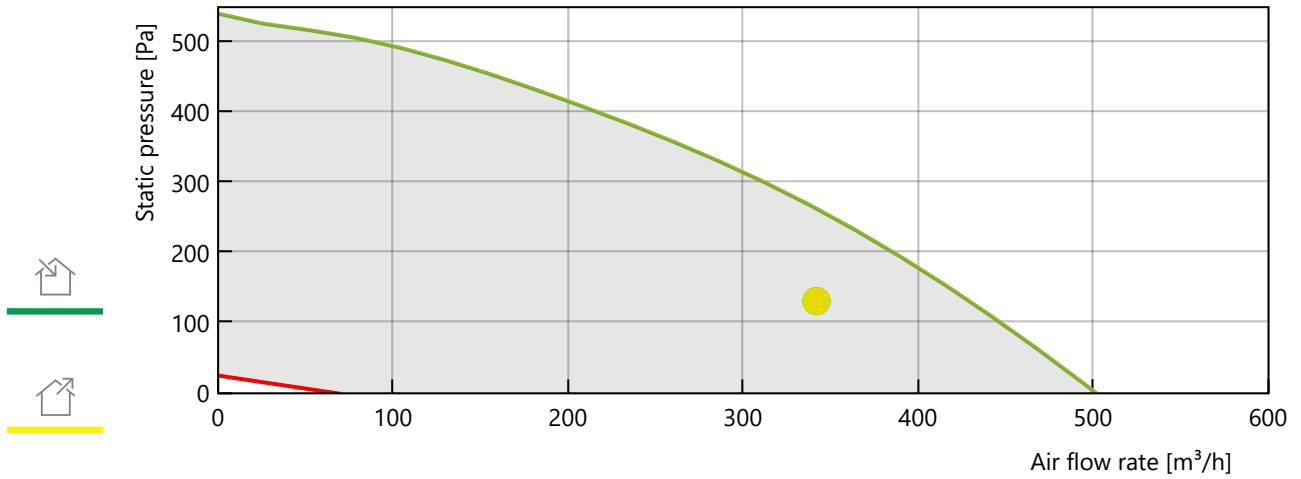

**Instructions**

<https://www.komfovent.com/>